

# TESTICORD Multi-purpose gauge having parallel carriage

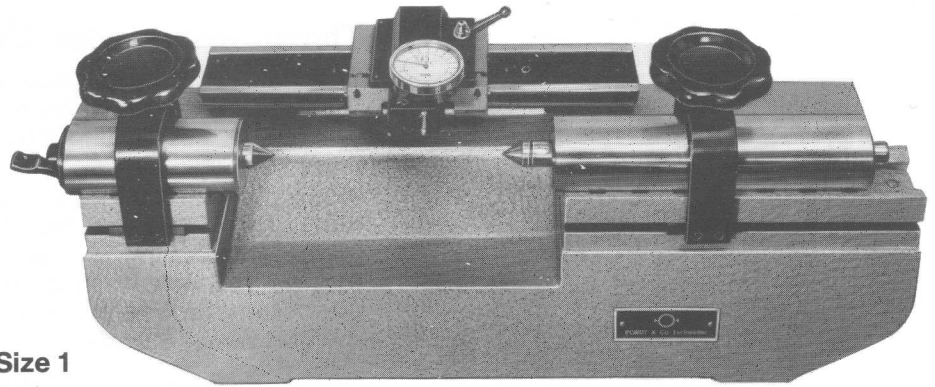

Type 6142 Size 1

The TESTICORD multi-purpose gauge Type 6142 is used for measuring diameters, threads, tapers, concentricity, face squareness, parallelism, eccentric relief etc. on workpieces and tools such as reamers, mills and taps.

- Finely lapped spindle sleeves of stainless steel mounted in aligned prisms
- Carbide tipped centres with rapid release
- Carriage on finely-lapped guide rails, running parallel to the centres
- Device for measuring spiral fluted reamers
- Attachment for gauging threads
- Device for measuring thread pitch
- Device for measuring squareness between thread axes and other workpiece axes and surfaces.
- Mechanical and optical dividing heads.

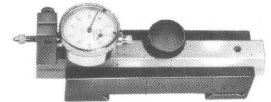

Type 6508

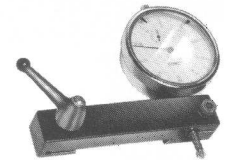

Type 6140-36

Technical information:	size 1 mm	size 2 mm
measuring travel of the parallel carriage	250	350
maximum diameter over the measuring distance	180	200
maximum distance between centres for workpiece diameters up to	420	550
	50	80
maximum distance between centres for workpiece diameters up to	240	440
	180	200
spindle sleeve	52	82

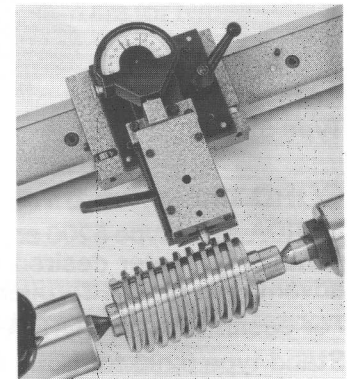

Type 6145

Accessories for Multi-Purpose Gauge Type 6142 Size 1 and 2

accessories for measuring an additional diameter:  
indicator support with slide and dial indicator with 0,01 mm divisions type 6508

accessories for measuring lengths:  
fixed stop type 6140-35 for the floating carriage  
support with indicator with 0,01 mm divisions type 6140-36  
support with micrometer spindle type 6140-37

set-up for measuring threads:  
floating carriage type 6145 for measuring threads with wires or prisms  
60° prism type 6860 for thread measurement

accessories for measuring squareness:  
measuring insert type 6897

setting cylinder for use when measuring diameters and for checking parallelism:  
setting cylinder 12 mm diameter 100 mm long type 6898  
setting cylinder 26 mm diameter 200 mm long type 6899

set-up type 6146 for accepting workpieces incorporating centres consisting of a spring-loaded spindle and interchangeable adaptor for the fixed spindle sleeve.

accessories only for the multi-purpose gauge type 6142 size 1:

adaptor type 6147 for 3-jaw chuck  
spindle type 6279 size 1 with Morse 3 taper  
spindle type 6283 size 1 for collets K 16 to standard DIN 6341  
dividing head type 6281 size 1 and dividing plate type 6282  
optical dividing heads on request

accessories for squareness measurement:  
spindles and adaptors of the squareness measuring equipment type 6200 are also usable for the multi-purpose gauge type 6142 size 1 (s. page 13)

accessories only for multi-purpose gauge type 6142 size 2:  
spindle type 6279 size 2 with Morse 3 taper  
spindle type 6283 size 2 for collets K 32 to standard DIN 6341  
dividing head type 6281 size 2 and dividing plate type 6282  
optical dividing heads on request

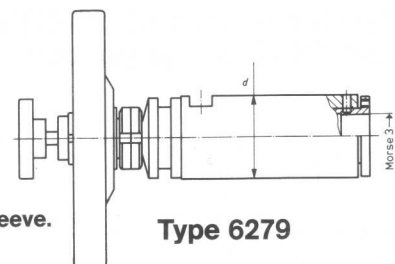

Type 6279

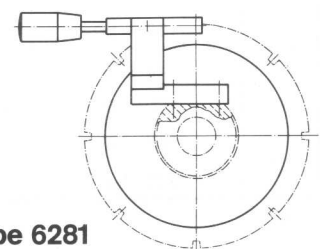

Type 6281